

JUV Wall Mount — Technical Specifications

Vertical Lift System

- Non-electric, adjustable worksurface provides full 26" (66 cm) of vertical adjustment. BIFMA ergonomic range: 22.6–48.7" (57.4–123.7 cm)
- Constant Force™ technology for easy, non-electric adjustment
- Surface supports up to 40 lbs (18.14 kg) for easiest lift experience

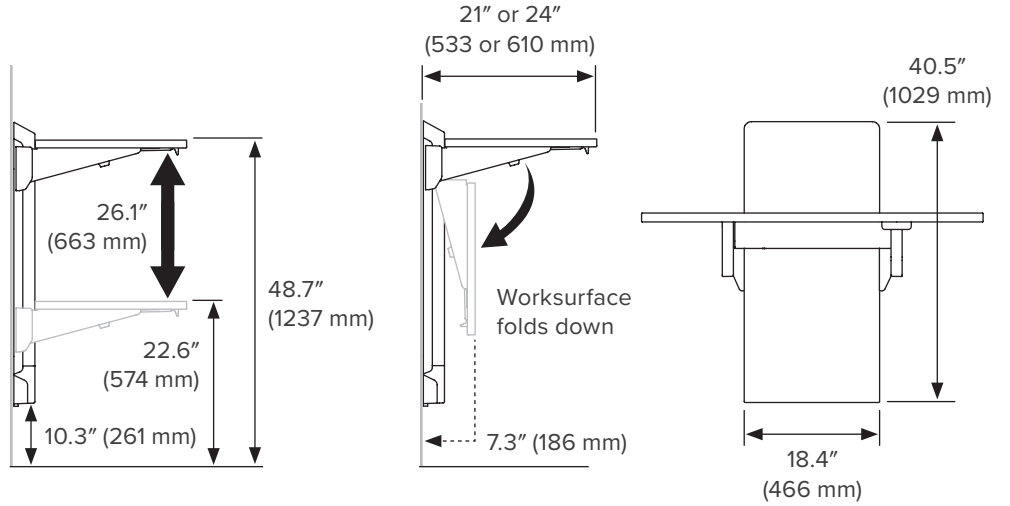

Charging Accessory/Power Options

- Integrated power and USB charging accessory available
- AC input: 120 v ~ 60 – Hz
- Max amps: 12A
- Includes 3 AC outlets and 2 USB jacks
- UL962 Certified

- Power cord provides access to outlets up to 69" (1753 mm) to the left and up to 48" (1219 mm) to the right
- When power is added, 1-piece access cover changes to 2-piece removable cover
- Includes tamper resistant receptacles

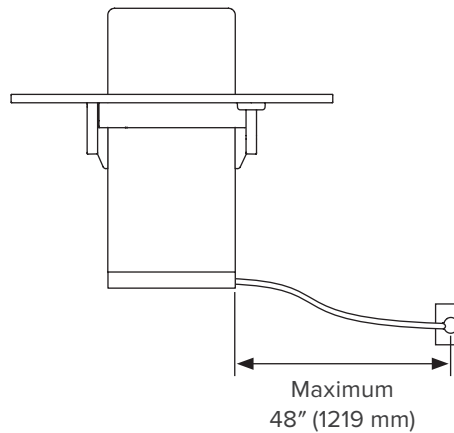
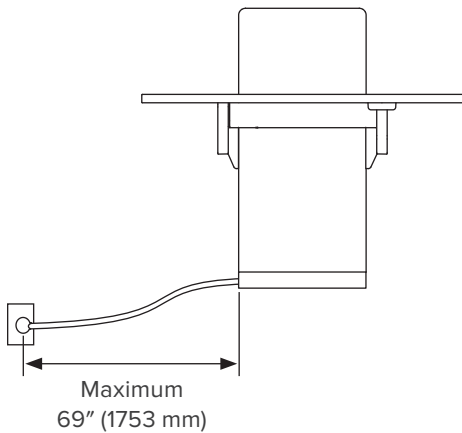
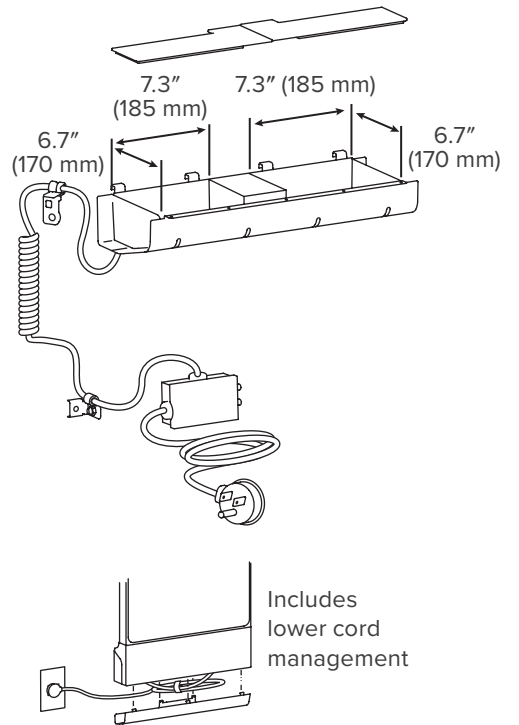

JUV Wall Mount — Technical Specifications

Surface

- Space-saving, flip-down worksurface
- 8 worksurface size options:
21" (533 mm) or 24" (610 mm) by
28" (711 mm), 34" (864 mm),
40" (1016 mm) or 46" (1168 mm)
- Worksurface edge is
.75" (19 mm) and includes
2 mm ABS edgeband
- Woodgrain runs width of
surface

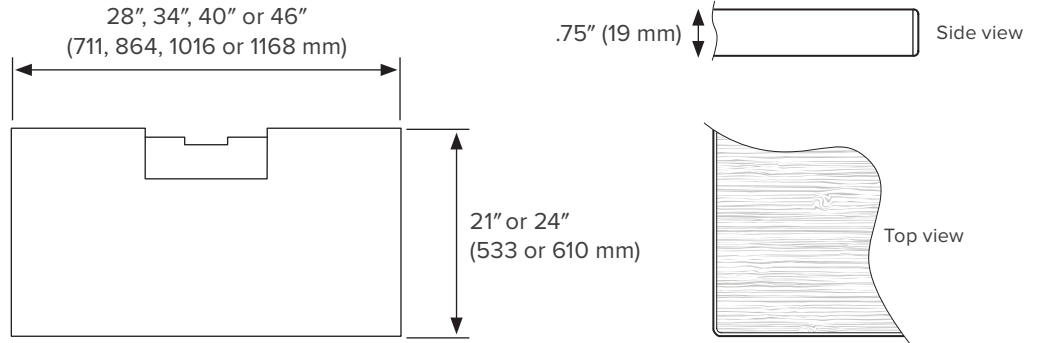

Multi-Unit Configuration

- Place units next to each other for multiple surfaces
- Allow enough space between units by adding 2" (50.8 mm) to the space between the center of each worksurface to eliminate pinch points

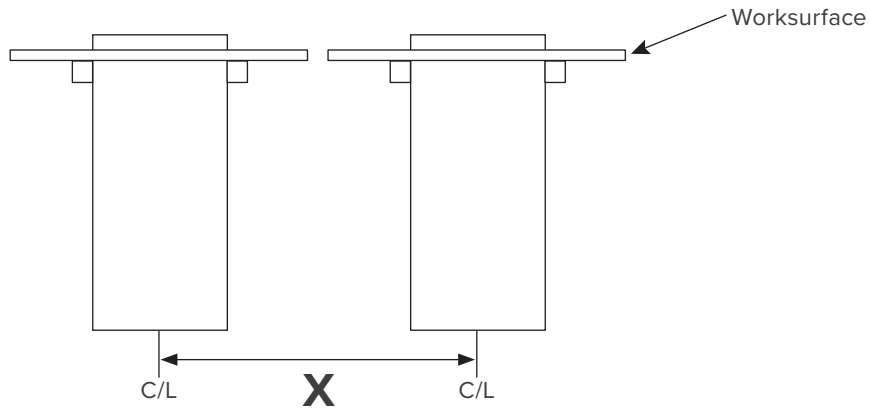

X = width of worksurface + 2" (50.8 mm) minimum

28" (533 mm) worksurface = 30" (762 mm) spacing

34" (863.6 mm) worksurface = 36" (914.4 mm) spacing

40" (1016 mm) worksurface = 42" (1066.8 mm) spacing

46" (1168.4 mm) worksurface = 48" (1219.2 mm) spacing

JUV Wall Mount Accessories — Technical Specifications

JUV Monitor Riser Accessory

- Integrates single or dual monitors
- Dual riser accommodates up to two 27" monitors
- Single LD monitor riser: 6–16 lbs (2.7–7.2 kg)
- Single HD monitor riser: 14–28 lbs (6.3–12.7 kg)
- Dual monitor riser: 14–28 lbs (6.3–12.7 kg)
- Risers include 5" (13 cm) lift
- Single monitor tilts 20° (-5°/+15°)
- Worksurface in flip-down position does not interfere with riser
- Distance from wall to front of VESA plate 7.25" (18.4 cm)
- Riser recommended on 24" (609.6 mm) deep worksurface only for optimal focal depth
- Includes universal VESA plate with quick attach bracket for easy install

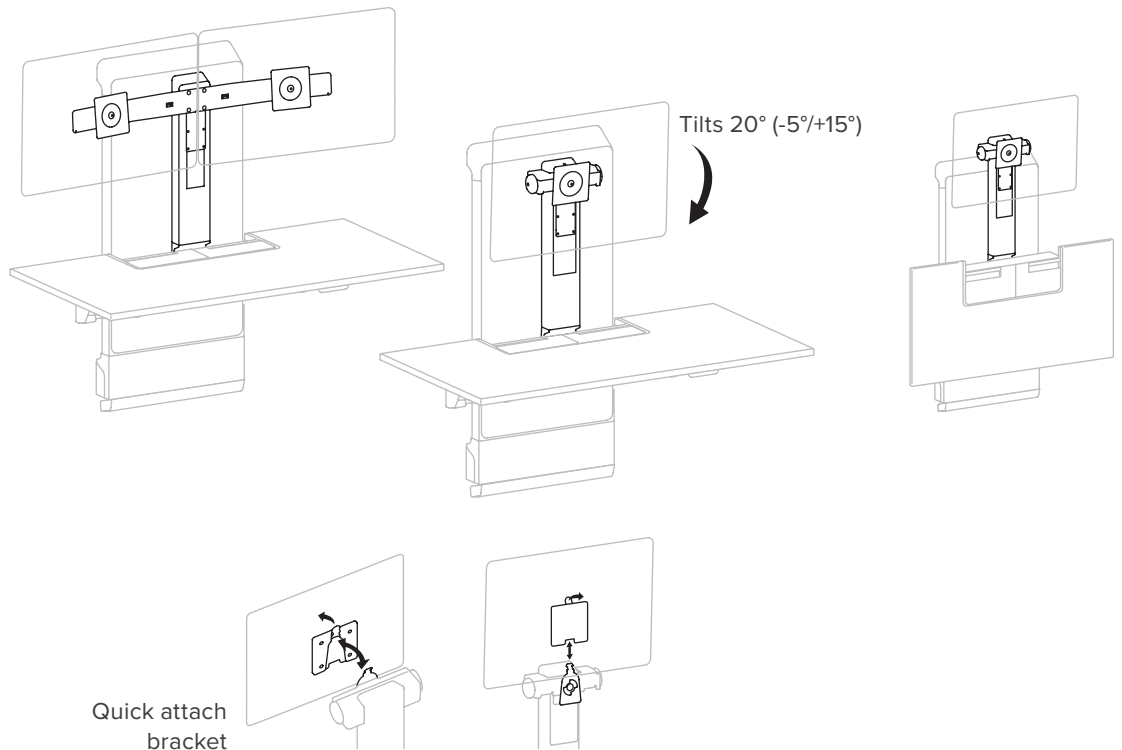

Coming Soon: Insert Options

- Field-applied laminate accessory
- Includes adhesive backer
- Non-removable
- Woodgrain runs vertically

